

# CAF<sup>®</sup> 316

made to last



The only sea-water resistant press fastener you can truly rely on



[WWW.CAF-316.COM](http://WWW.CAF-316.COM)



made to last

## FINALLY: A PRESS FASTENER YOU CAN TRULY RELY ON

Hardly anybody realizes that press fasteners used in the tough conditions like marine applications are not even resistant to sea water - until now! Probably the smallest item on deck is now available in real 316 stainless steel: CAF-316®. At last modern technology tackles a long-standing problem: making press fasteners truly corrosion free.



### CORROSION FREE

CAF-316 is a press fastener, made of the high-quality material 316 Stainless Steel. Flawlessly surviving the 1.000 hrs. salt-spray test (DIN 9772 by COT 'no corrosion').

### RELIABLE

The spring inside the socket is made of high-quality duplex stainless steel, making sure the fasteners performance is stable over time and use, without deformation or loss of holding force. Successfully passing the 50.000 opening action test, no matter the conditions.

### EASY TO INSTALL

Installation is like a normal press fastener (self-piercing shaft) using the same application tools, from hand punch to full automatic machines.

## SETTING NEW STANDARDS

As true reliability drills down to every detail, CAF-316 uses spring technology that avoids galvanic corrosion or electrolysis, while ensures a similar and stable spring performance as one is used to and should expect. In detail, the CAF-spring material has a complex crystal structure (austenitic and ferritic) to make it even harder, more elastic and better corrosion resistant than regular stainless steel (304 and 316). Good to know, this crystal structure has one known side effect of causing magnetism. All products are tailored for their use and application, using screw-threads designed for their purpose. And above all, full sea water resistant. Accept no compromise.

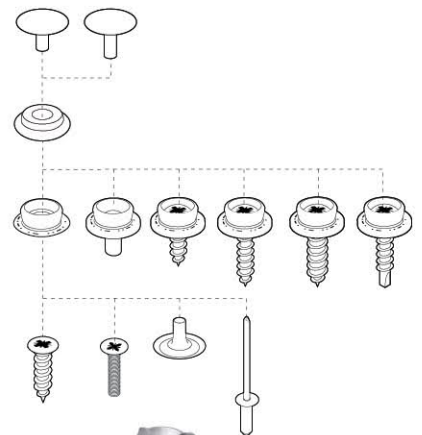

### HOLDING FORCE PERFORMANCE

comparing holding force performance of different socket-case and socket-spring material configurations, considering corrosion resistance after several open- and closing-actions

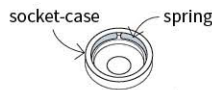
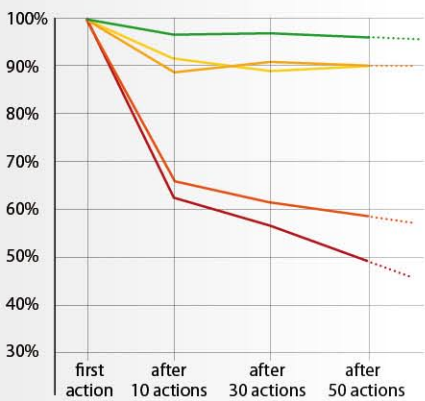

Leganda-items:	corrosion resistant	reliable spring
case: 316 stainless steel spring: duplex stainless steel <b>CAF-spring</b>	✓	✓
case: brass-nickel spring: brass (common / regular snap)	✗	✓
case: 304 stainless steel spring: phosphor-bronze (high risk of galvanic corrosion)	✗	✓
case: 304 stainless steel spring: 304 stainless steel	~	✗
case: 316 stainless steel spring: 316 stainless steel	✓	✗

Conclusion: when corrosion resistance is required, CAF-316 provides the only reliable configuration.



standard | optimised screw

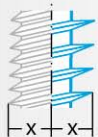

optimised for composite and wood applications up to 50% better hold than standard tapping screw

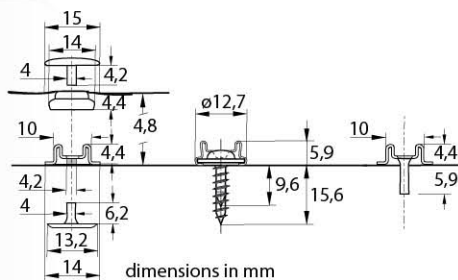

for more info, video and installation: [WWW.CAF-316.COM](http://WWW.CAF-316.COM)

# PARTS



CAF-316 Cap (A)	product	code	package
normal shaft 4,2mm (11/64") polished SS 316 ø 15mm	SS 316 BLACK	210000-100	100 x
	SS 316 BLACK MATT	210000-1000	1000 x
	SS 316 PEARL WHITE	210001-100	100 x
	SS 316 GREY	210002-100	also available in 1000 x
	SS 316 KHAKI	210003-100	
	SS 316 NAVY BLUE	210004-100	
	SS316 BORDEAUX RED	210005-100	
	SS316 BLACK OXIDE	210006-100	
	SS316 BLACK OXIDE	210007-100	
	SS316 BLACK OXIDE	210010-100	
long shaft 6,2mm (1/4") polished SS 316 ø 15mm	polished SS 316	210100-100	100 x
		210100-1000	1000 x



CAF-316 Socket (B)	product	code	package
socket	SS 316	220000-100	100 x
	with special CAF-spring	220000-1000	1000 x
socket	BLACK OXIDE SS 316	220010-100	100 x
	with special CAF-spring	220010-1000	1000 x



CAF-316 Stud (C)	product	code	package
stud	SS 316	230000-100	100 x
	mid-base	230000-1000	1000 x
stud	BLACK OXIDE SS 316	230010-100	100 x
	mid-base	230010-1000	1000 x
screw-stud 10mm (3/8")	SS 316	230110-100	100 x
	with optimised thread	230110-1000	1000 x
screw-stud 16mm (5/8")	SS 316	230116-100	100 x
	with optimised thread	230116-1000	1000 x
screw-stud oversized 16mm (5/8")	SS 316	230316-100	100 x
	with optimized thread	230316-1000	1000 x
screw-stud self-drilling 16mm (5/8")	SS 316	230416-100	100 x
	with optimized thread	230416-1000	1000 x
gipsy-stud 5,9mm (15/64")		230206-100	100 x
		230206-1000	1000 x

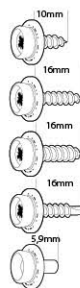

CAF-316 Fixing (D)	product	code	package
tapping screw	4,2 x 16 C-Z A4	140100-100	100 x
		140100-1000	1000 x
M4 bolt	M4 x 16 DIN965-Z A4	140200-100	100 x
		140200-1000	1000 x
blind rivet	4,0 x 10 DIN 7337B SS 304 A2	141300-100	100 x
		141300-1000	1000 x
eyelet (D) 6,2mm (1/4")	SS 316	140500-100	100 x
		140500-1000	1000 x
eyelet (D) 6,2mm (1/4")	BLACK OXIDE SS 316	240510-100	100 x
		240510-1000	1000 x

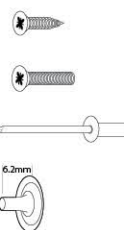

# TOOLS



Tools to apply stainless steel CAF-316 items in fabric.

product	code	package
Pres'nSnap pliers incl. 4 dies	190500-1	1 x comp. set
Pres'nSnap pliers excl. dies	190501-1	1 plier
4 dies (A & B, C & D)	190502-1	4 dies
2 dies (A & B)	190503-1	2 dies
2 dies (C & D)	190504-1	2 dies
hand punch-set (A & B, C & D)	190600-1	1 set
hand punch-set (A & B)	190601-1	1 set
hole punch 4 mm	190700-1	
screw-stud adaptor (PZ)	290100-1	





For the latest news on development and availability,  
please visit: [WWW.CAF-316.COM](http://WWW.CAF-316.COM)

CAF (patented and registered trademark)  
is another solution from SUREFAS

**CAF<sup>®</sup> 316**

made to last

by **SURE FAS<sup>®</sup>**